



DESERT WATER AGENCY

TURF Buy Back
Grants



HOW-TO GUIDE

CALCULATE PROJECT SQUARE FOOTAGE

Tools you will need:

- Measuring tape or measuring wheel
- Graph paper ([free templates available online](#))

*If your yard is mostly square, the directions will help. If you have a lot of curvature, or more complex footage calculations, you will need assistance from your contractor or landscaper. The landscaper may provide square footage as part of their bid for your conversion.

Step 1: Utilize the graph paper to make a drawing of your home and the borders of your yard. Write in any descriptions of nearby items such as driveways, fences, or sidewalks. This will help you orient yourself.

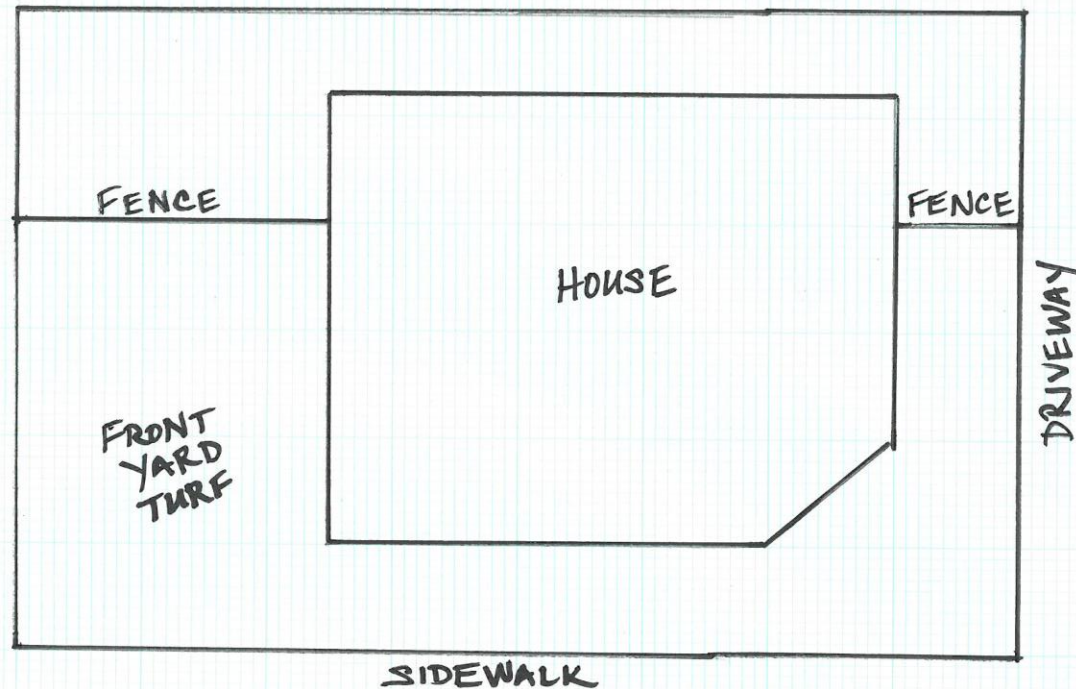

Visit www.dwa.org/turf

Step 2: Divide the project area into easily measured shapes such as rectangles, squares, triangles and circles.

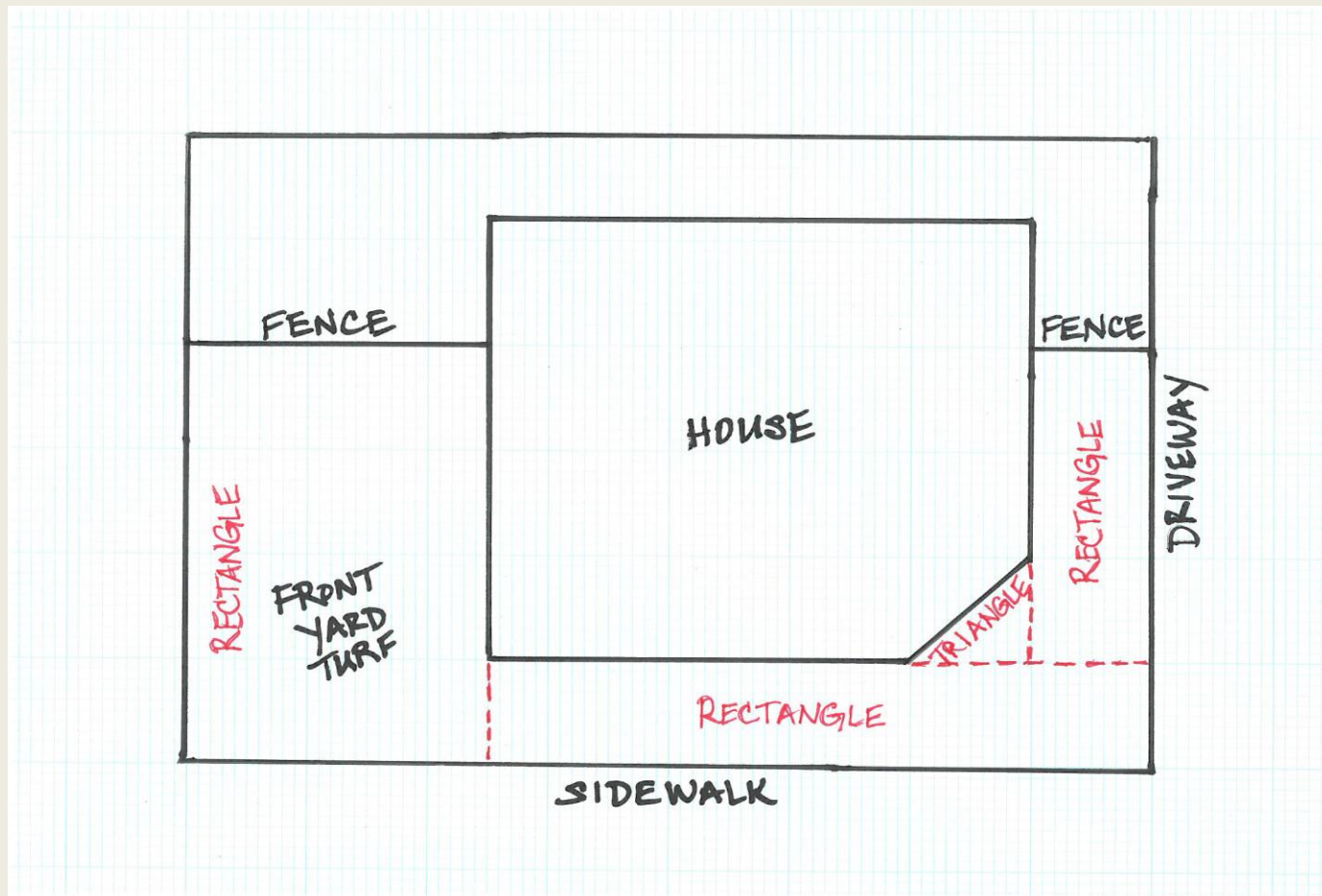

Visit www.dwa.org/turf

DESERT WATER

Step 3: Take measurements to find out the square footage of each shape in your yard. Then add up the square footage of each shape for total square footage.

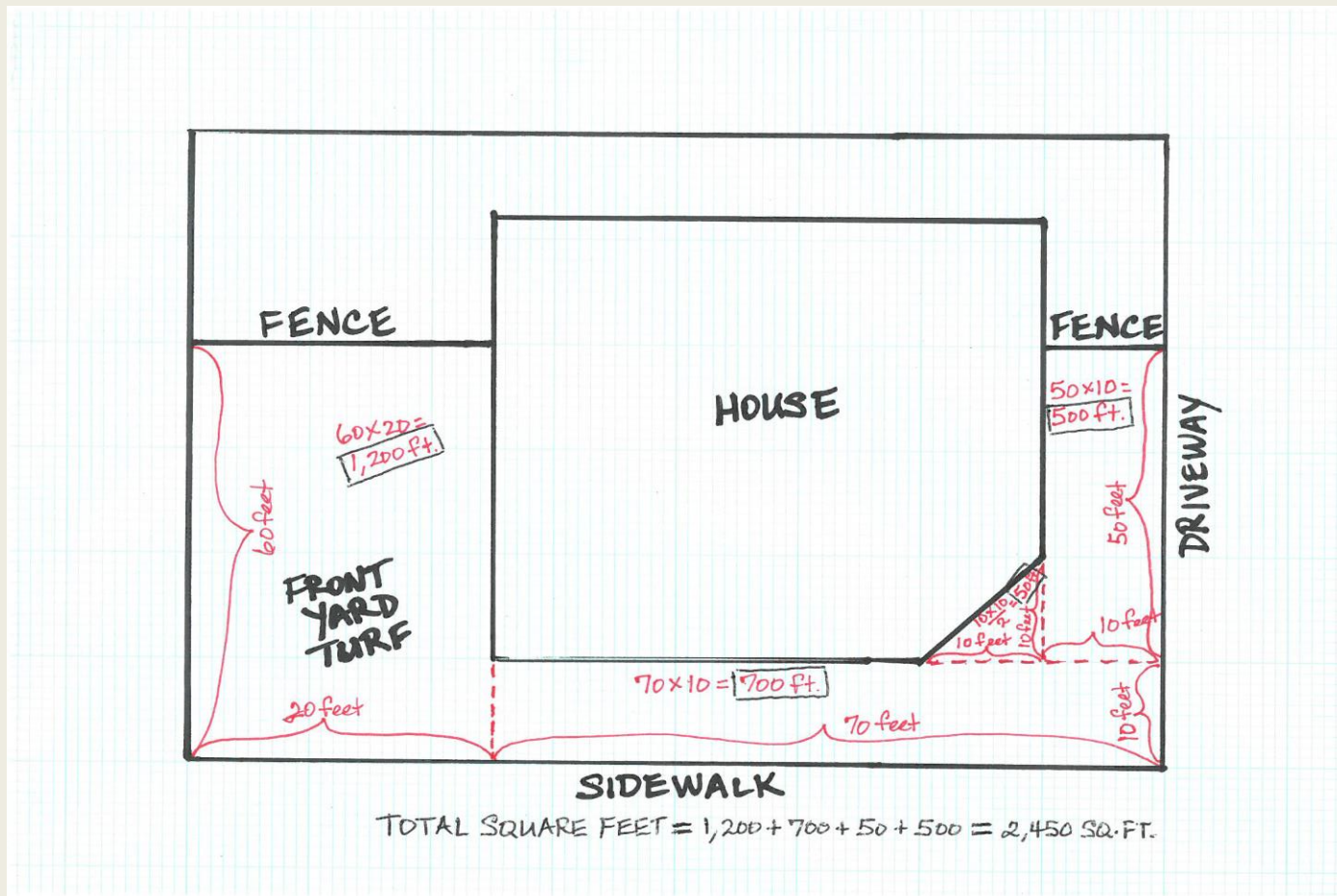

Visit www.dwa.org/turf

Formulas to find square footage

Square or Rectangle:

Height multiplied by Width = Square Footage

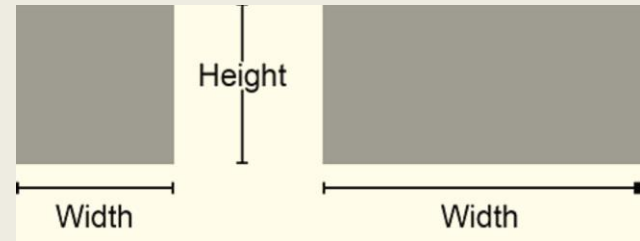

Triangle:

Height multiplied by Width and divided by
2 = Square Footage

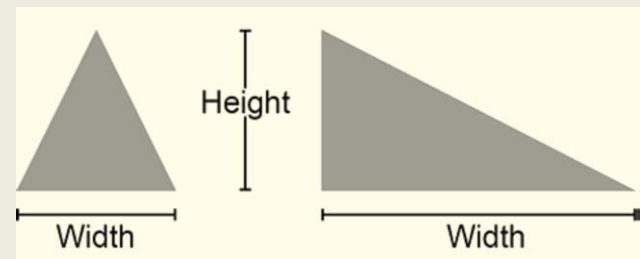

Visit www.dwa.org/turf

DESERT WATER

Note:

Accuracy in footage is very important. We cannot increase your footage after your project has been approved, so please try to provide as accurate information as possible in your application. The program may review your requested footage and reduce the project area if a discrepancy is found. **Discrepancies may lead to removal from the program.**

Visit www.dwa.org/turf

